

Underhook/In-Line Strain Gauge Lift Link with Remote Telemetry Linked Display

LIFT LINK SYSTEM

ET Series

Telemetry Linked Version



- Ranges 1 tonne to 100 tonne
- Designed for use with standard Lifting Shackles
- Sealed to IP65
- Robust Construction
- Accuracy 0.25% typical
- Range up to 200 metres
- Auto Power Down
- Up to 255 links can be used in a single installation
- **3 YEAR WARRANTY**

Options Available

Rechargeable batteries and charger
(for handheld receiver only)

418MHz version for use in the USA

Bow or D type Shackles

Wire Linked Version

DESCRIPTION

The ET series of Lift Link Load Cells has been specifically developed for the measurement of cable tension and under hook crane/lifting gear weighing.

The accuracy achieved by the ET series is unrivalled in its price range and combines high quality with excellent value for money. The weight and overall height of the ET series is much lower than that offered by other manufacturers, therefore reducing the headroom required for the installed system.

The ET is environmentally sealed to IP65 to give excellent waterproofing properties for use outside in arduous conditions. The instrument is housed in a robust ABS enclosure with leather protective case. Operating at 433.92MHz (418MHz on USA version), the operator has only 3 front panel tactile switches ON/OFF, HOLD and TARE. The 8 character alpha numeric display is 7mm high, and has 5 digit resolution. Both link and instrument include automatic power down, when not in use, to conserve battery life and are addressable to enable up to 255 units to be used on one installation. Each ET Telemetry Lift Link system is supplied in a rugged carrying case with calibration certificate and full supporting documentation.

It comes with Applied Measurements standard 3 year warranty.

Transducer Specialists...

APPLIED MEASUREMENTS LIMITED

3 MERCURY HOUSE - CALLEVA PARK - ALDERMASTON - BERKSHIRE - RG7 8PN - UK

Tel: (+44) 0118 981 7339 Fax: (+44) 0118 981 9121 email: info@appmeas.co.uk Internet: www.appmeas.co.uk



SPECIFICATION

| CHARACTERISTICS | ET LIFT LINK |
|----------------------------------|------------------------------------|
| Ranges (F.R.): | 1, 2, 5, 12, 25, 35, 50, 100 tonne |
| Accuracy: | < 0.25% FR typical. |
| Temperature Range: | -10 to +80 °C |
| Safe Overload: | 2 x F.R. |
| Ultimate Overload: | 5 x F.R. |
| Construction: | Anodised Aluminium Alloy |
| Environmental Protection: | IP65 |
| Transmission Range: | 200 metres |
| Battery Life: | 200 hrs continuous |
| Battery: | 2 x 3.6V lithium |
| Auto Power Down: | 9 hrs from power on |

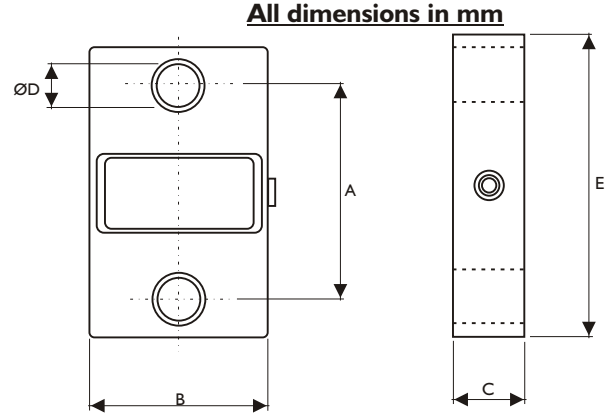

| RANGE | A | B | C | ØD | E | WEIGHT |
|-----------|-----|-----|-----|------|-----|--------|
| 1, 2, 5 t | 108 | 105 | 40 | Ø30 | 164 | 1.4kg |
| 12 t | 120 | 105 | 40 | Ø38 | 210 | 1.9kg |
| 25 t | 131 | 125 | 55 | Ø53 | 255 | 4kg |
| 35 t | 147 | 135 | 55 | Ø60 | 305 | 5kg |
| 50 t | 170 | 150 | 75 | Ø73 | 345 | 9kg |
| 100t | 228 | 220 | 123 | Ø100 | 455 | 27kg |

| CHARACTERISTICS | HAND HELD DISPLAY |
|----------------------------------|--|
| Display: | 8 Character Alpha Numeric 7mm high LCD |
| Keyboard: | 3 key tactile ON/OFF, HOLD, TARE |
| Battery: | 9V PP3 lithium (1.2Ah) |
| Battery Life: | 10 hours minimum |
| Frequency: | 433.92MHz UK and Europe / 418MHz (USA) |
| Auto Power Down: | After 5 minutes in "Waiting" mode |
| Temperature Range: | -10 to +55 °C |
| Environmental Protection: | IP65 |
| Weight: | 420gms with leather case |

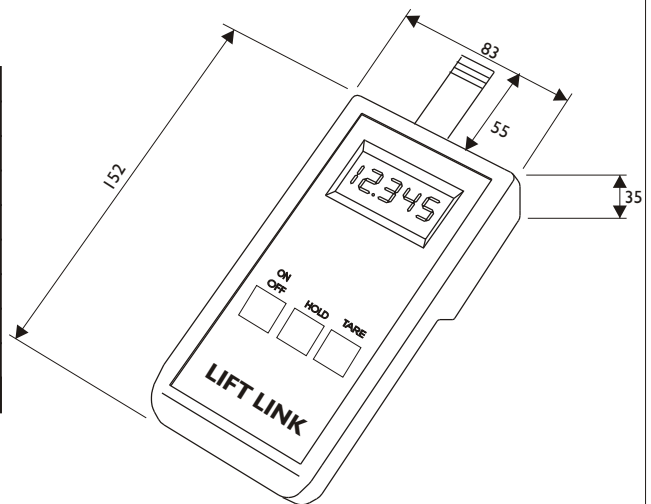

All dimensions in mm

